

SKETCH/AREA TABLE ADDENDUM

SUBJECT INFO

File No.: Parcel No.: R023402100000033.055.
 Property Address: 3336 Hartsfield Way E
 City: Mobile County: Mobile State: AL ZipCode: 36695
 Owner: SSK Asset Management, LLC
 Client: Prime Design Homes, LLC Client Address: 210 Portside Blvd, Mobile, AL 36695
 Appraiser Name: Inspection Date: 05/18/2017

SKETCH

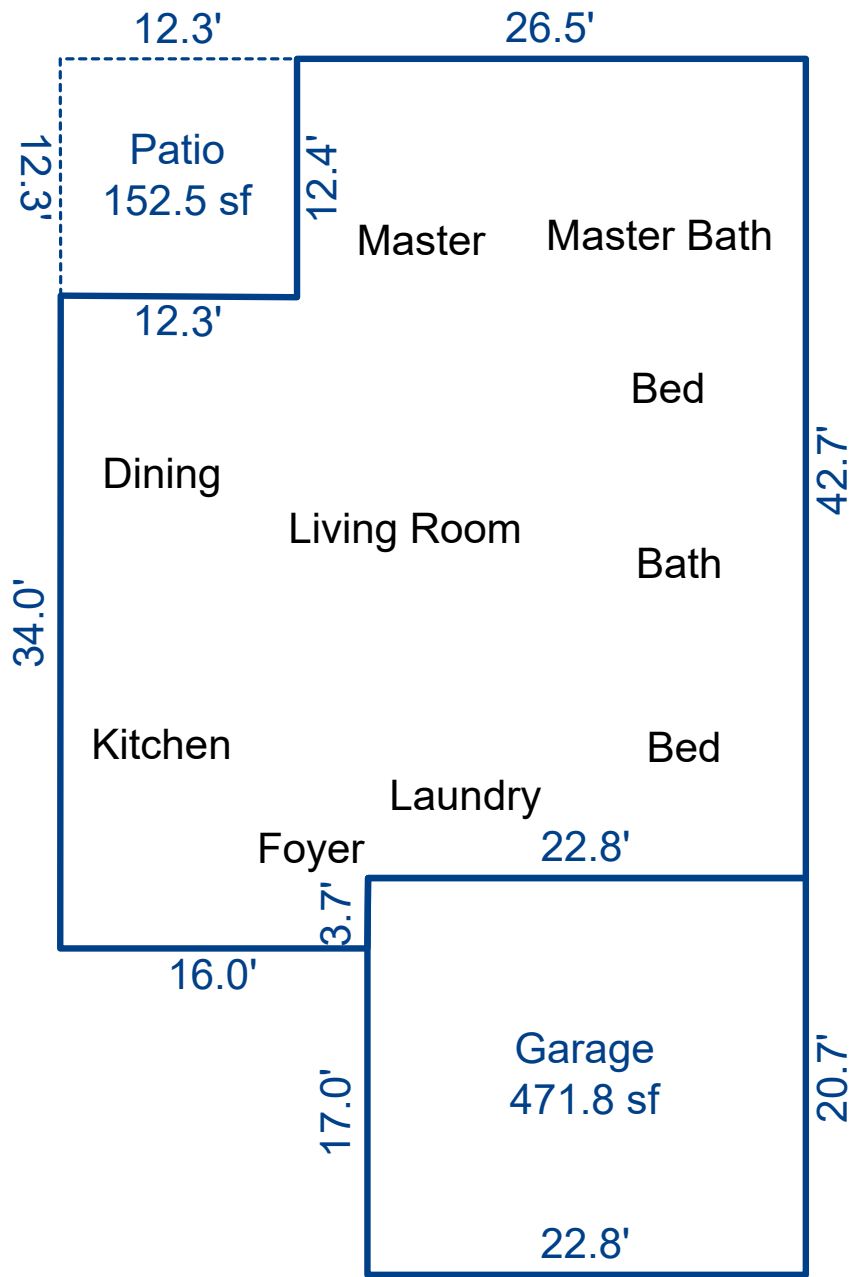

Sketch by Apex Sketch

AREA CALCULATIONS SUMMARY						AREA CALCULATIONS BREAKDOWN				
Code	Description	Factor	Net Size	Perimeter	Net Totals	Name	Base x	Height x	Width =	Area
GLA1	First Floor	1.0	1562.6	170.4	1562.6	First Floor	0.5 x	3.7 x	0.0 =	0.1
GAR	Garage	1.0	471.8	87.0	471.8			30.3 x	22.8 =	690.7
P/P	Patio	1.0	152.5	49.4	152.5			33.9 x	3.7 =	124.4
							0.5 x	33.9 x	0.2 =	3.9
							0.5 x	12.1 x	0.1 =	0.5
							0.5 x	33.9 x	0.2 =	3.5
								33.9 x	12.1 =	410.5
								26.5 x	12.4 =	329.0
	Net LIVABLE		(rounded)		1,563	8 total items			(rounded)	1,563